



© Jeff Doel

Denver, Colorado, United States, 2008

TABLE OF CONTENTS

DIAMOND TOOLS

DOWN THE HOLE

DRILL RIGS

PUMPS

DRILLING ADDITIVES & LUBRICANTS

SURVEY SYSTEMS

ACCESSORIES

GEOTECHNICAL EQUIPMENT



Montreal, Canada
Phone 514.336.9211
Toll-free 1.800.768.7274
Fax 514.745.4125
info@fordia.com

The Fordia Catalogue is a publication intended for internal and external distribution. The entire content of this publication, including but not limited to text, design, photographs and graphics, is the property of Fordia. Reproduction in whole or in part without written permission from Fordia is prohibited. Features and technical specifications are subject to change without notice. All weights and measurements are approximate.

To order a copy of this catalogue, please contact your sales representative.

ONE CLEAR FOCUS

Fordia's goal is simple - to develop and distribute the best diamond tools, equipment and accessories to small and large businesses specializing in core drilling for the mineral exploration and geotechnical industries.

That is our mission. How we live it is our strength. We provide exceptional service, demonstrated daily by our worldwide representatives. Our distribution network ensures Fordia products can be delivered globally, right on schedule. We are highly committed to quality and innovation.

Luc Paquet
President

Alain Paquet
Vice-President

Denis Landry
Executive VP & General Manager

OUR COMMITMENT TO TOTAL QUALITY

Fordia has always been at the forefront of excellence in the mining industry.

At Fordia, quality means providing products and services on time that comply with our customers' specific requirements at competitive prices. To achieve this, every employee strives to reach this level of quality the first time and at all times.

This commitment to excellence requires processes that ensure our manufacturing methods, business management, employee training and product development all foster quality and continuous improvement.

In order to uphold our dedication to total quality, Fordia continuously invests in the development of its management system and ensures all employees are involved in maintaining quality.

At Fordia, quality is a commitment.

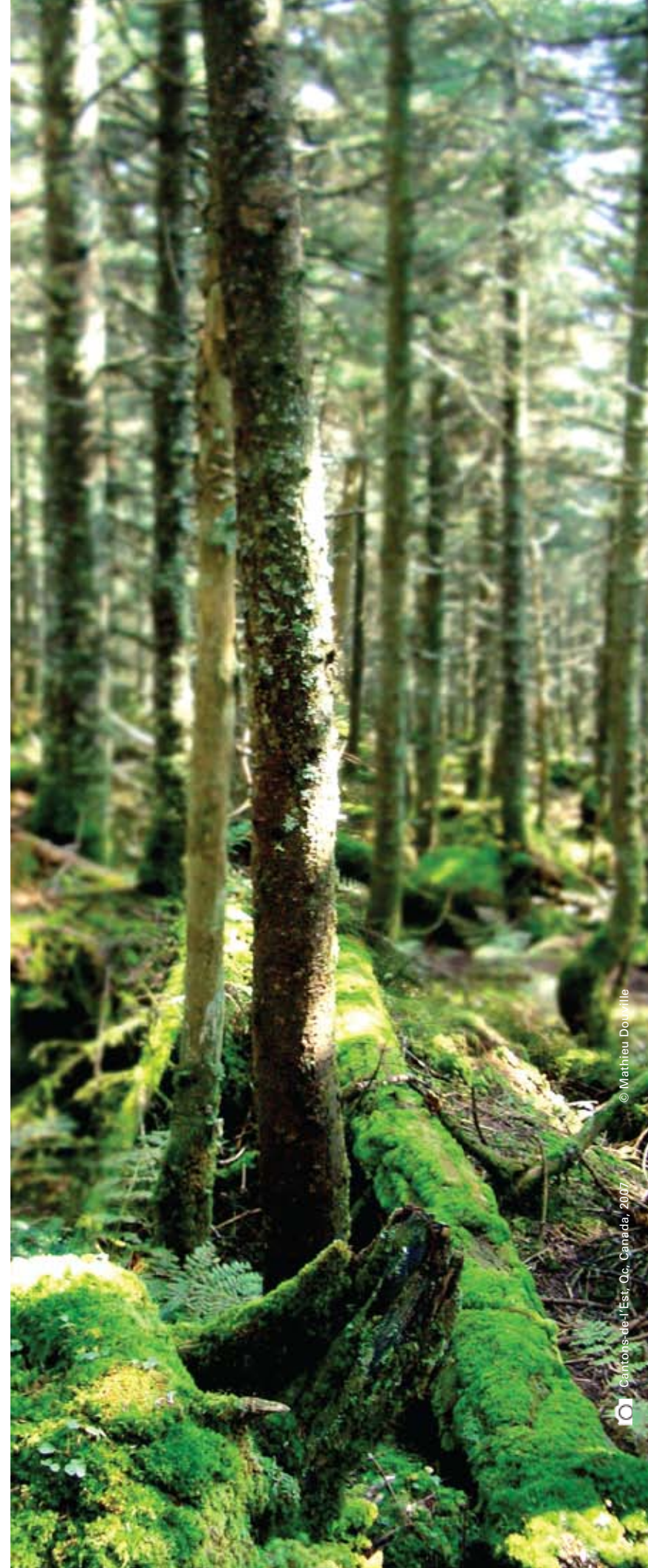

© Mathieu Drouille

Cantons-de-l'Est, Qc, Canada, 2007





“Diamond drill rigs are the heart of any drill site – they deliver the drive and are closely related to productivity, efficiency and results. In that sense, we believe that supplying drill rigs is an inclusive part of offering a global drilling solution, and that’s why we put so much energy in providing the best drill rigs and the best service possible.”

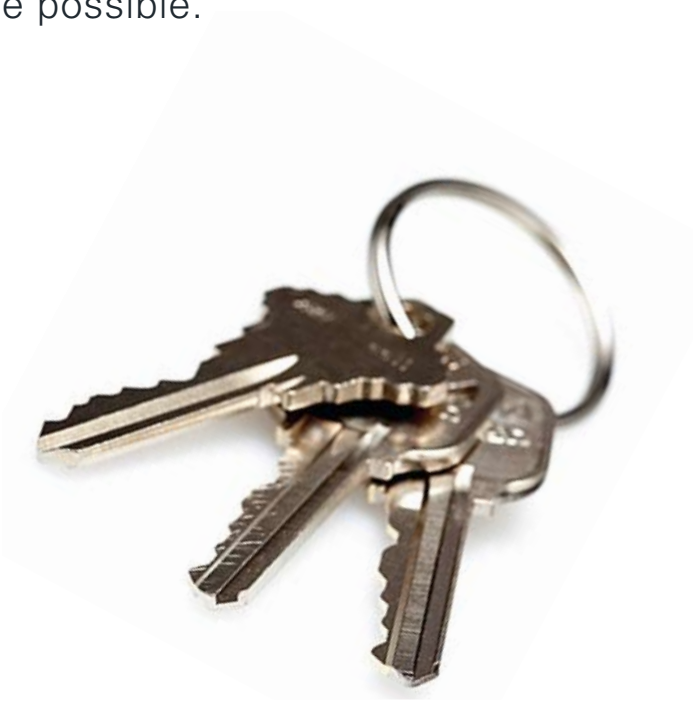

DRILL RIGS

TABLE OF CONTENTS

SILVER BEAR A5 1300m N	8-11
GOLDEN BEAR 1400m N	12-15
VERSADRILL KmB .4S & KmB .4	16-21
VERSADRILL KmB .8S & KmB .8	22-27
VERSADRILL KmB 1.4S & KmB 1.4	28-33

DRILL RIGS	34-35
COMPARATIVE CHART	
HYDRAULIC MUD MIXERS	37



SILVER BEAR A5 1300m N

SURFACE DRILL RIG

The Fordia Silver Bear A5 1300m N is a great heliportable surface drill rig. Mounted on two separate and compact skids, it combines pure power with convenience for transportation in mountainous or remote areas. Designed and produced in conjunction with structural and hydraulic engineers, the Silver Bear A5 is a powerful machine meant to drill hard.



Silver Bear A5 1300m N
Part No. 20-100

SILVER BEAR A5 1300m N

SURFACE DRILL RIG

BASE

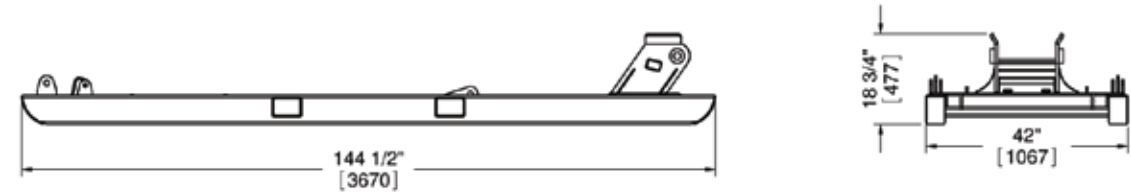

SHAFT

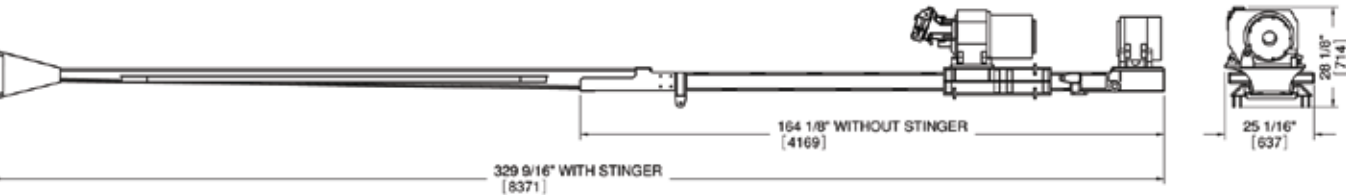

POWER SKID

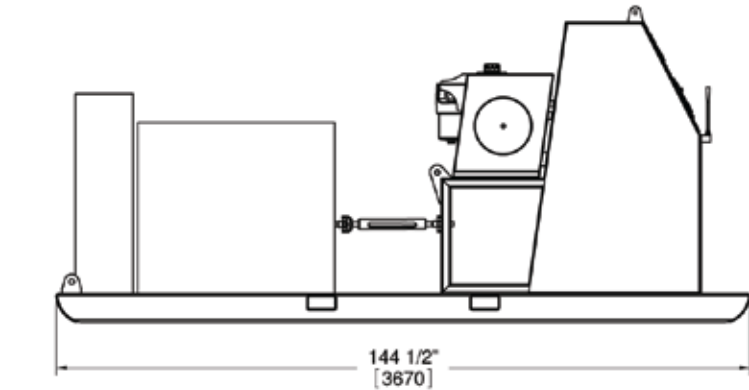

CONTROL PANEL

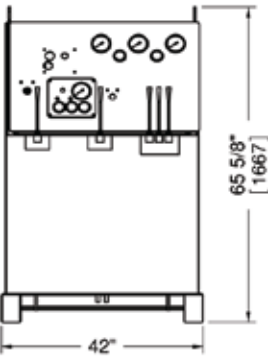

SILVER BEAR A5 1300m N

SURFACE DRILL RIG

DEPTH RATING WITH TWO CYLINDERS*

	METRIC (m)	IMPERIAL (ft)
BWL	1,700 m	5,600 ft
NWL	1,325 m	4,350 ft
HWL	850 m	2,800 ft

*Approximation only. May vary according to soil conditions. Depth will be derated with single cylinder.

WEIGHT (HEAVIEST PARTS)

	METRIC (kg)	IMPERIAL (lbs)
MAST ASSEMBLY & HEAD	1,633 kg	3,600 lbs
POWER PACK SKID AND CONTROL PANEL	1,678 kg	3,700 lbs
TOTAL	3,311 kg	7,300 lbs

POWER UNIT

	HP	STD/OPT
ISUZU 4-CYLINDERS	140 hp	STANDARD
ISUZU 6-CYLINDERS	160 hp	OPTIONAL
CATERPILLAR C6.6 6-CYLINDER	185 hp	OPTIONAL

ROTARY HEAD ASSEMBLY

	DESCRIPTION
MOTOR	160 CC
HOLDING CAPACITY	26,000 lbs (11,793 kg)
MAXIMUM TORQUE	2,341 N/m (1,727 lbs/ft)
MAXIMUM SPEED	1600 RPM
TRANSMISSION	TWO-SPEED (5:4:1 AND 3:1)

FEED FRAME ASSEMBLY

	DESCRIPTION
HEAD STROKE	1.83 m (6 ft)
PULL CAPACITY (WITH ONE CYLINDER)	6,804 kg (15,000 lbs)
PULL CAPACITY (WITH TWO CYLINDERS)	13,608 kg (30,000 lbs)
ANGLE RANGE	-90° to -22°

WIRELINE HOIST ASSEMBLY

STANDARD	
CABLE CAPACITY	1,240 m (4,065 ft)
PULL CAPACITY (EMPTY)	1,474 kg (3,250 lbs)
PULL CAPACITY (FULL)	510 kg (1,125 lbs)
OPTIONAL	
CABLE CAPACITY	1,707 m (5,600 ft)
PULL CAPACITY (EMPTY)	1,474 kg (3,250 lbs)
PULL CAPACITY (FULL)	454 kg (1,000 lbs)



GOLDEN BEAR 1400m N

SURFACE DRILL RIG

The Fordia Golden Bear 1400m N is a powerful and reliable drill rig for diamond drilling. Its modular design simplifies handling and assembly and the rig can be upgraded by changing the feed cylinder and the rotary motor, if greater depth capacity is needed. Efficient and built tough for durability, the Fordia Golden Bear 1400m N is perfect for surface applications. For more convenience, the Golden Bear rig can be mounted either on a skid, on a trailer or on Caterpillar tracks upon request.



Golden Bear 1400m N
Part No. 20-200

GOLDEN BEAR 1400m N

SURFACE DRILL RIG

BASE

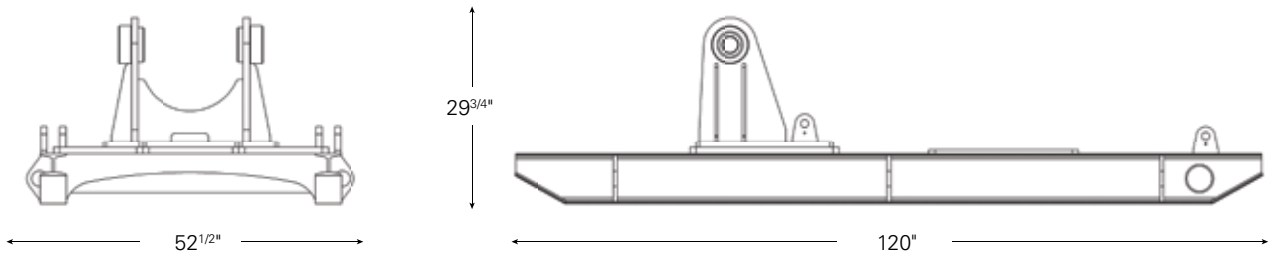

SHAFT

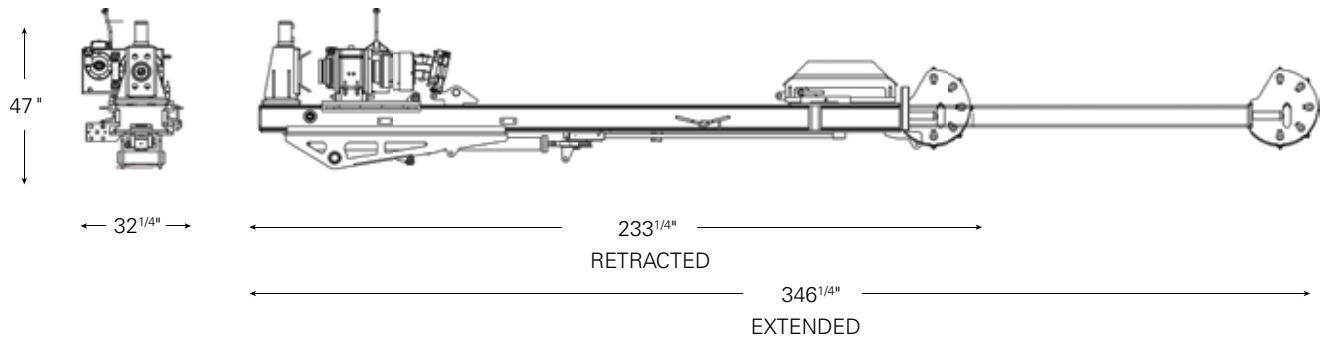

CONTROL PANEL

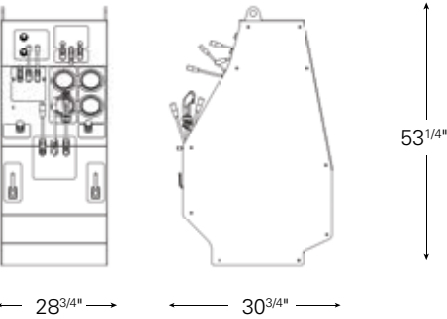

POWER PACK

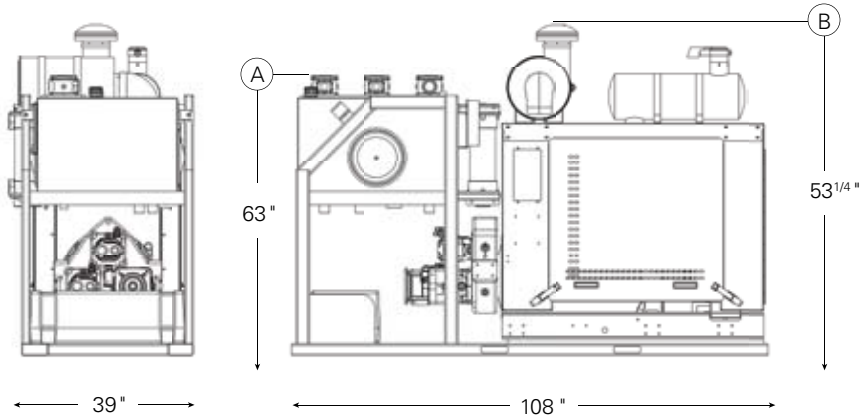

GOLDEN BEAR 1400m N

SURFACE DRILL RIG

DEPTH RATING*

SIZE	METER	FEET
BWL	1,800 m	5,900 ft
NWL	1,400 m	4,600 ft
HWL	900 m	2,950 ft

*Approximation only. May vary according to soil conditions.

WEIGHT

	METRIC (Kg)	IMPERIAL (Lbs)
MAST ASSEMBLY	4,164 kg	9,180 lbs
POWER UNIT (WITH DIESEL ENGINE & WET HYDRAULICS)	2,386 kg	5,260 lbs
CONTROL UNIT	454 kg	1,000 lbs
TOTAL	7,003 kg	15,440 lbs

POWER UNIT

	HP	STD/OPT
CUMMINS DIESEL ENGINE	185 HP	STANDARD
CUMMINS DIESEL ENGINE	265 HP	HIGH ALTITUDE OPTION

ROTARY HEAD ASSEMBLY

	DESCRIPTION
MOTOR*	80 cc
HOLDING CAPACITY	26,000 lbs (11,793 kg)
MAXIMUM TORQUE	1,386 lb/ft
MAXIMUM SPEED	1,250 RPM
TRANSMISSION	FOUR-SPEED (5:4:1 AND 3:1)

*Chuck operation: spring closed and hydraulically opened.

FEED FRAME ASSEMBLY

	DESCRIPTION
HEAD STROKE	3 m (10 ft)
PULL CAPACITY	6,350 kg (14,000 lbs)
ANGLE RANGE	-90° to -40°

WIRELINE HOIST ASSEMBLY

STANDARD	
CABLE CAPACITY	2,438 m (8,000 ft)
PULL CAPACITY (EMPTY)	1,633 kg (3,600 lbs)
PULL CAPACITY (FULL)	544 kg (1,200 lbs)
OPTIONAL	
CABLE CAPACITY	1,707 m (5,600 ft)
PULL CAPACITY (EMPTY)	1,474 kg (3,250 lbs)
PULL CAPACITY (FULL)	454 kg (1,000 lbs)



© Gilles Savois

Val-d'Or, Qc, Canada, 2005



VERSADRILL KmB .4S & KmB .4

SURFACE AND UNDERGROUND DRILL RIG

The Versadrill kmB .4 has a depth capacity of 400 m (1,300 ft) with B rods and fits the need for a lightweight long stroke portable drill rig.

Designed in conjunction with industry contractors, this practical machine is perfect for surface applications but can easily be adapted for underground drilling as well - minimizing the capital cost for organizations that offer both services. It can be made out of steel or aluminum, depending of customers' specifications, and can be mounted either on a skid, a trailer or Caterpillar tracks upon request.



Versadrill KmB .4S
Part No. 20-301

Versadrill KmB .4
Part No. 20-309

VERSADRILL KmB .4S

SURFACE DRILL RIG

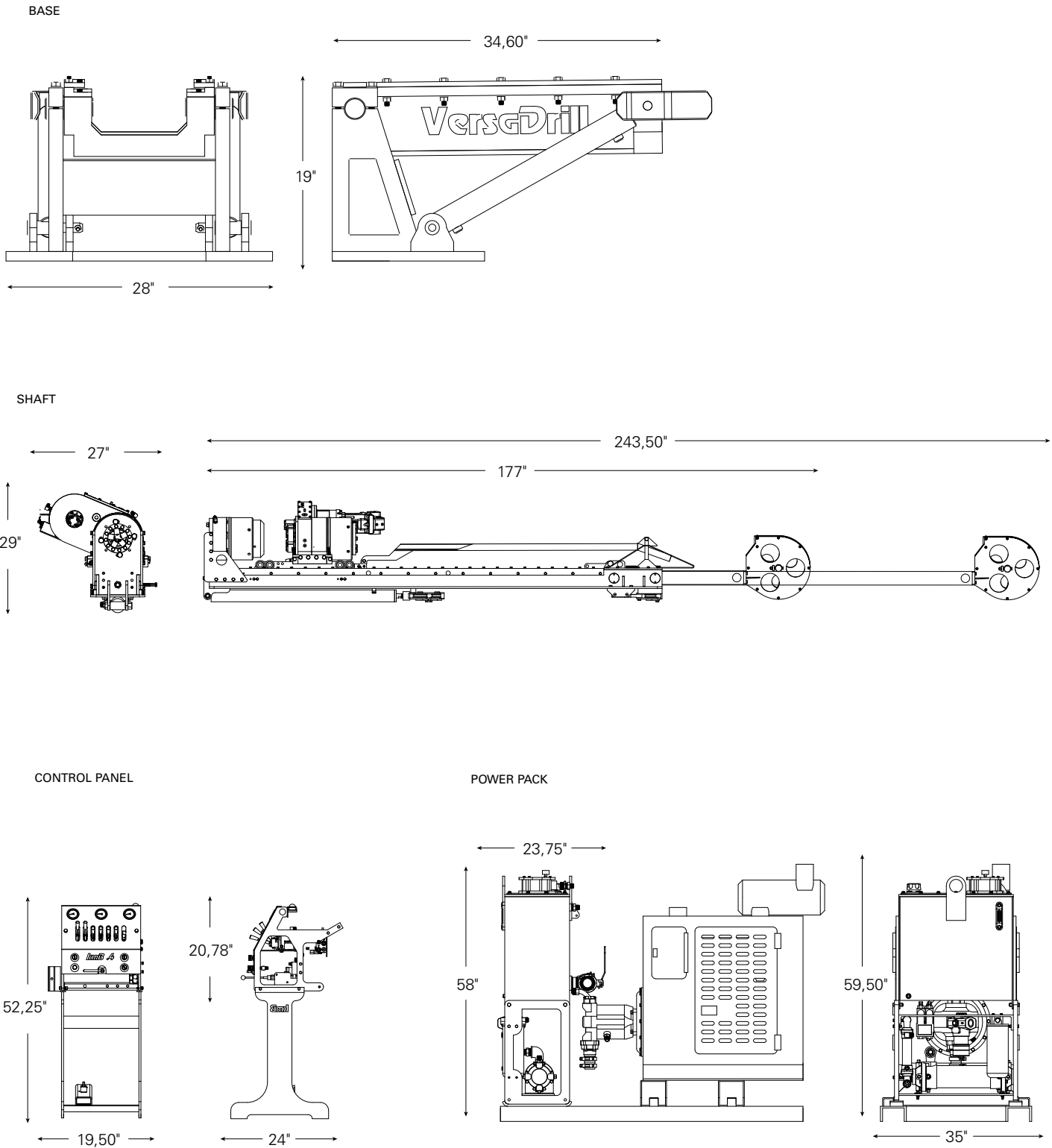

VERSADRILL KmB .4S

SURFACE DRILL RIG

DEPTH RATING*

SIZE	METER	FEET
AWL	472 m	1,550 ft
BWL	400 m	1,300 ft
NWL	200 m	655 ft
HWL	55 m	180 ft
HW Casing	30 m	98 ft

*Approximation only. May vary according to soil conditions.

WEIGHT

	METRIC (Kg)	IMPERIAL (Lbs)
MAST ASSEMBLY	862 kg	1,900 lbs
POWER UNIT (WITH DIESEL ENGINE AND WET HYDRAULICS)	741 kg	1,634 lbs
CONTROL PANEL	97 kg	214 lbs
TOTAL	1,700 kg	3,748 lbs

*Surface option is not included.

POWER UNIT

	HP	STD/OPT
CUMMINS DIESEL ENGINE	100 HP	STANDARD

ROTARY HEAD ASSEMBLY

	DESCRIPTION
MOTOR*	80 cc variable
HOLDING CAPACITY	14,000 lbs (6,350 kg)
MAXIMUM TORQUE	2,840 N/m (2,098 lbs/ft)
MAXIMUM SPEED	1,500 rpm
TRANSMISSION	Two-speed (3.46:1 and 1:1)

*Chuck operation: spring closed and hydraulically opened.

FEED FRAME ASSEMBLY

	DESCRIPTION
HEAD STROKE	1.83 m (6 ft)
PULL CAPACITY	5,670 kg (12,500 lbs)
ANGLE RANGE	-45° to -90°

WIRELINE HOIST ASSEMBLY

	STANDARD
CABLE CAPACITY	457 m (1,500 ft)
PULL CAPACITY (EMPTY)	907 kg (2,000 lbs)
PULL CAPACITY (FULL)	295 kg (650 lbs)

VERSADRILL KmB .4

SURFACE AND UNDERGROUND DRILL RIG

BASE

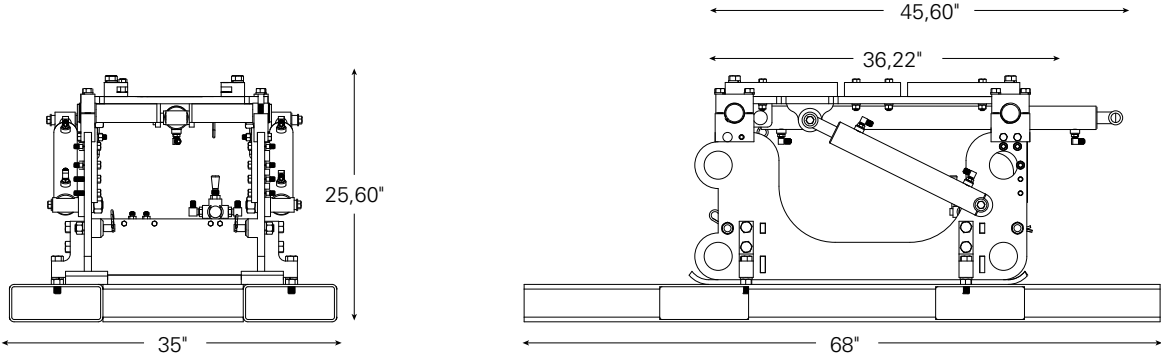

SHAFT

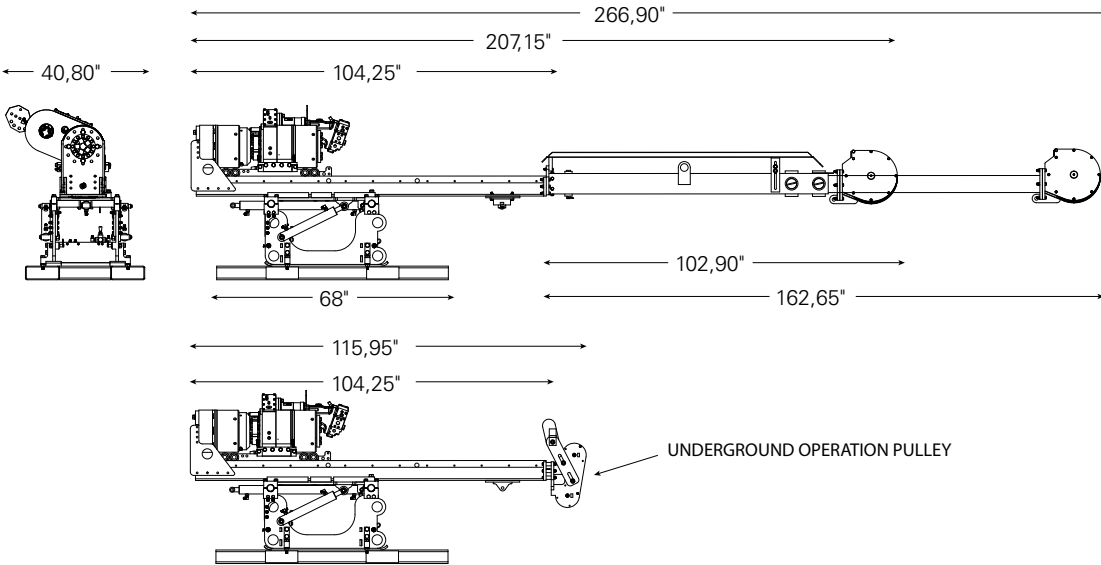

CONTROL PANEL

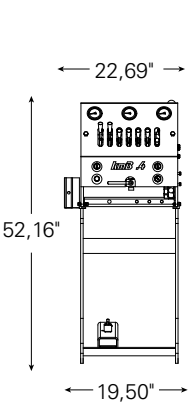

POWER PACK

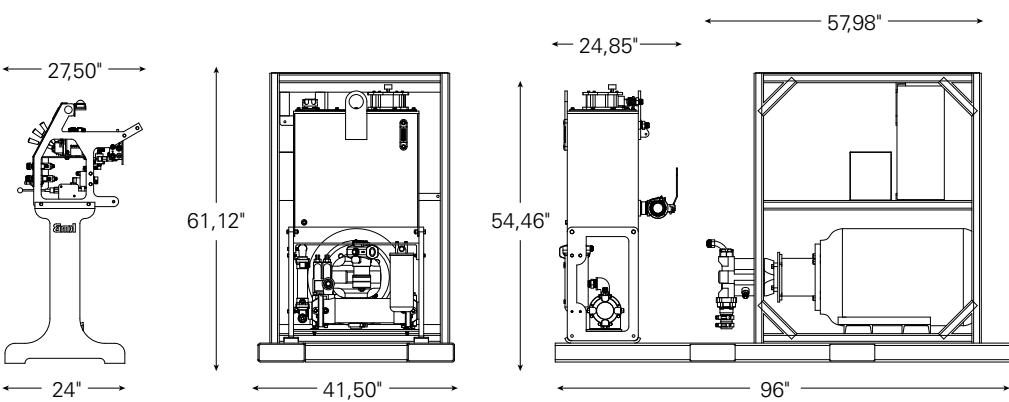

VERSADRILL KmB .4

SURFACE AND UNDERGROUND DRILL RIG

DEPTH RATING*

SIZE	METER	FEET
AWL	472 m	1,550 ft
BWL	400 m	1,300 ft
NWL	200 m	655 ft
HWL	55 m	180 ft
HW CASING	30 m	98 ft

*Approximation only. May vary according to soil conditions.

WEIGHT

	METRIC (kg)	IMPERIAL (lbs)
MAST ASSEMBLY	807 Kg	1,780 lbs
POWER UNIT (WITH ELECTRIC ENGINE AND WET HYDRAULICS)	1,014 Kg	2,236 lbs
CONTROL PANEL	97 kg	214 lbs
TOTAL	1,919 kg	4,230 lbs

*Surface option is not included.

POWER UNIT

	HP	STD/OPT
HYUNDAI ELECTRIC ENGINE	75 HP	STANDARD
CUMMINS DIESEL ENGINE	100 HP	STANDARD

NOTE: Please contact your sales representative to choose the appropriate power unit according to the electrical system effective in the country of use.

ROTARY HEAD ASSEMBLY

	DESCRIPTION
MOTOR*	80 cc variable
HOLDING CAPACITY	14,000 lbs (6,350 kg)
MAXIMUM TORQUE	2,840 N/m (2,098 lbs/ft)
MAXIMUM SPEED	1,500 rpm
TRANSMISSION	TWO-SPEED (3.46:1 AND 1:1)

*Chuck operation: spring closed and hydraulically opened.

FEED FRAME ASSEMBLY

	DESCRIPTION
HEAD STROKE	1.68 m (5 ft 6 in)
PULL CAPACITY	4,080 kg (9,000 lbs)
ANGLE RANGE (UNDERGROUND)	-90° to 90°
ANGLE RANGE (SURFACE)	0° to -90°

WIRELINE HOIST ASSEMBLY

	STANDARD
CABLE CAPACITY	457 m (1,500 ft)
PULL CAPACITY (EMPTY)	907 kg (2,000 lbs)
PULL CAPACITY (FULL)	295 kg (650 lbs)



VERSADRILL KmB .8S & KmB .8

SURFACE AND UNDERGROUND DRILL RIG

The Versadrill kmB .8 offers a great depth rating to weight ratio with its 800 m (2,600 ft) capacity with B rods.

Designed in conjunction with industry contractors, this practical machine is perfect for surface applications, but can easily be adapted for underground drilling as well - minimizing the capital cost for organizations that offer both services. It can be made out of steel or aluminum, depending of customers' specifications, and can be mounted either on a skid, a trailer or Caterpillar tracks upon request.

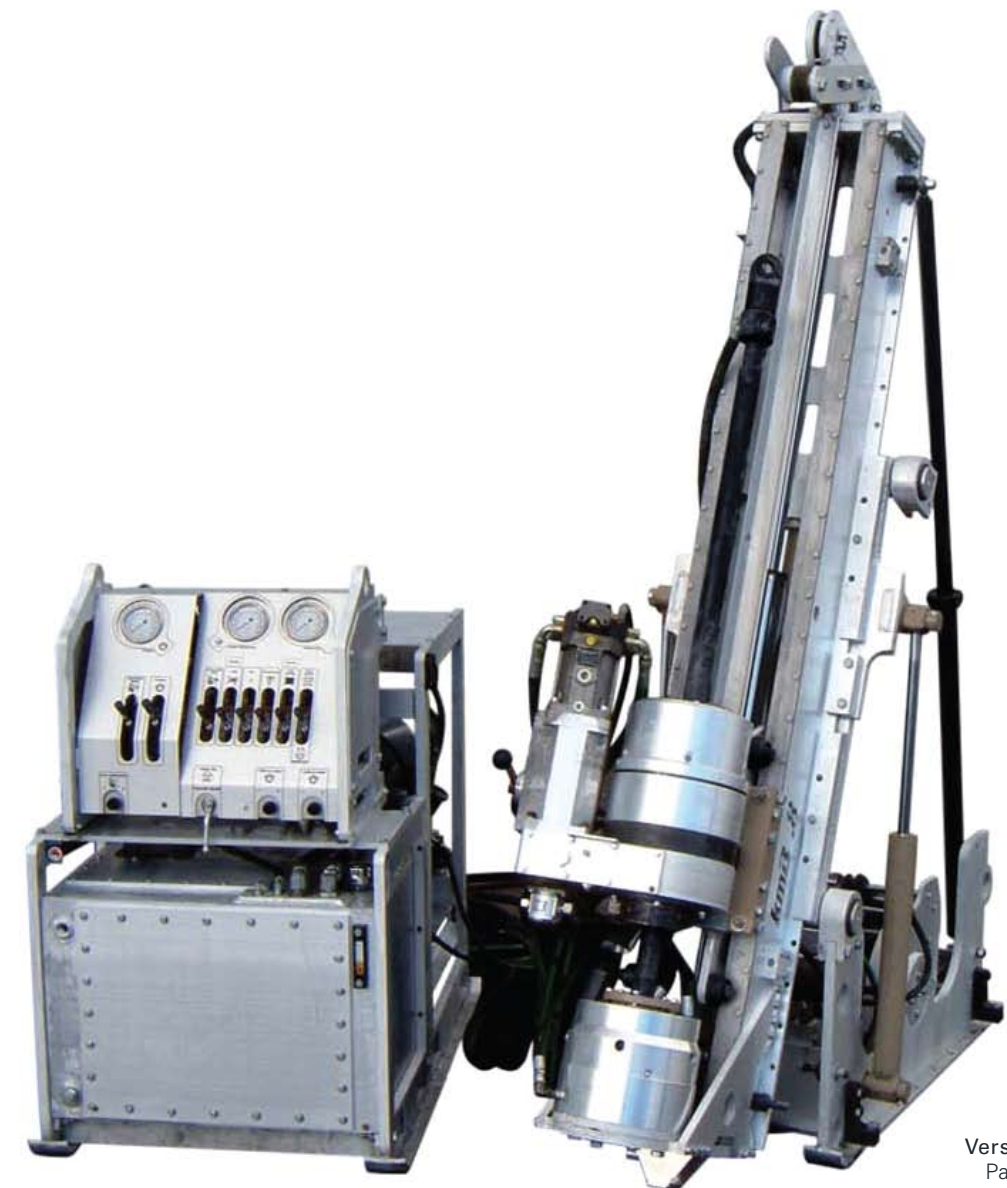

Versadrill KmB .8S
Part No. 20-302

Versadrill KmB .8
Part No. 20-310

VERSADRILL KmB .8S

SURFACE DRILL RIG

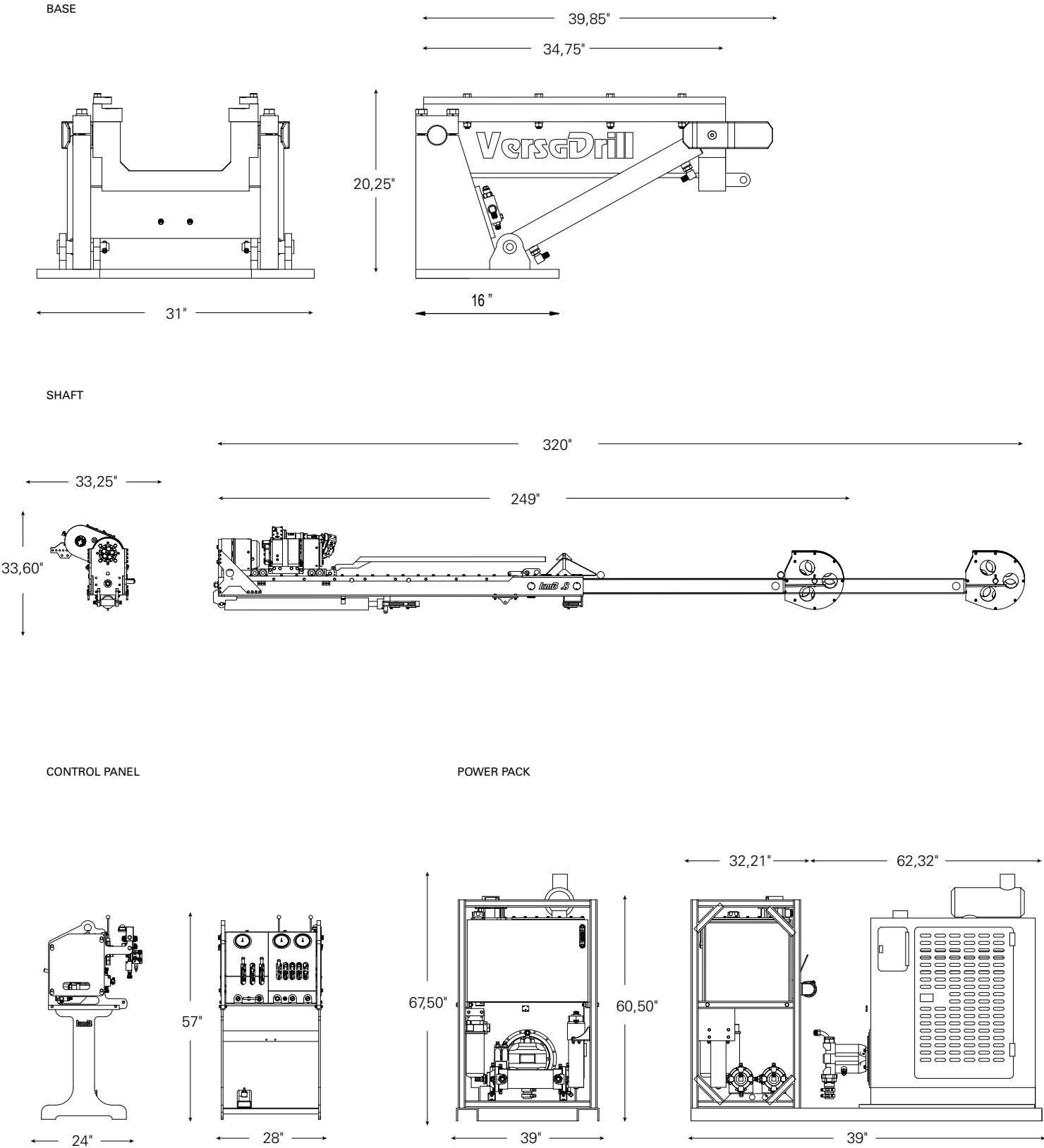

VERSADRILL KmB .8S

SURFACE DRILL RIG

DEPTH RATING*

SIZE	METER	FEET
BWL	800 m	2,600 ft
NWL	450 m	1,476 ft
HWL	200 m	655 ft
PWL	70 m	230 ft

*Approximation only. May vary according to soil conditions.

WEIGHT

	METRIC (kg)	IMPERIAL (lbs)
MAST ASSEMBLY	1,318 kg	2,905 lbs
POWER UNIT (WITH ELECTRIC ENGINE AND WET HYDRAULICS)	1,098 kg	2,420 lbs
CONTROL PANEL	231 kg	510 lbs
TOTAL	2,647 kg	5,835 lbs

POWER UNIT

	HP	STD/OPT
DIESEL ENGINE CUMMINS	140 HP	STANDARD

ROTARY HEAD ASSEMBLY

	DESCRIPTION
MOTOR*	80 cc variable
HOLDING CAPACITY	20,000 lbs (9,000 kg)
MAXIMUM TORQUE	2,840 N/m (2,098 lbs/ft)
MAXIMUM SPEED	1500 RPM
TRANSMISSION	Two-speed (3.46:1 and 1:1)

*Chuck operation: spring closed and hydraulically opened.

FEED FRAME ASSEMBLY

	DESCRIPTION
HEAD STROKE	1.83 m (6 ft)
PULL CAPACITY	8,300 kg (18,000 lbs)
ANGLE RANGE	-45° to -90

WIRELINE HOIST ASSEMBLY

	STANDARD
CABLE CAPACITY	915 m (3,000 ft)
PULL CAPACITY (EMPTY)	907 kg (2,000 lbs)
PULL CAPACITY (FULL)	295 kg (650 lbs)

VERSADRILL KmB .8

SURFACE AND UNDERGROUND DRILL RIG

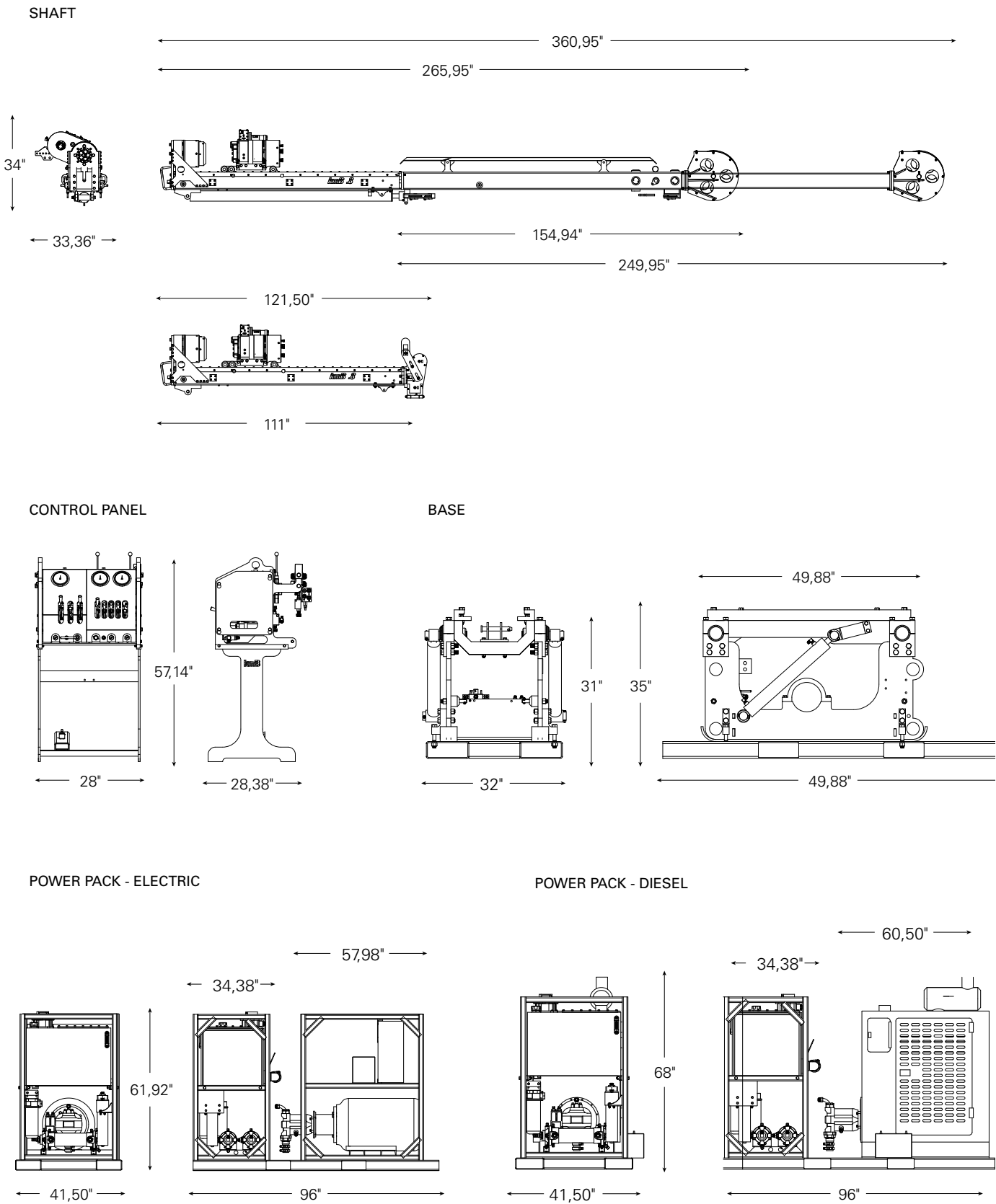

VERSADRILL KmB.8

SURFACE AND UNDERGROUND DRILL RIG

DEPTH RATING*

SIZE	METER	FEET
BWL	800 m	2,600 ft
NWL	450 m	1,476 ft
HWL	200 m	655 ft
PWL	70 m	230 ft

*Approximation only. May vary according to soil conditions.

WEIGHT

	METRIC (kg)	IMPERIAL (lbs)
MAST ASSEMBLY	1,318 kg	2,905 lbs
POWER UNIT (WITH ELECTRIC ENGINE AND WET HYDRAULICS)	1,225 kg	2,700 lbs
CONTROL PANEL	231 kg	510 lbs
TOTAL	2,774 kg	6,115 lbs

*Surface option is not included.

POWER UNIT

	HP	STD/OPT
HYUNDAI ELECTRIC ENGINE	100 HP	STANDARD
CUMMINS DIESEL ENGINE	140 HP	STANDARD

NOTE: Please contact your sales representative to choose the appropriate power unit according to the electrical system effective in the country of use.

ROTARY HEAD ASSEMBLY

	DESCRIPTION
MOTOR*	80 cc variable
HOLDING CAPACITY	20,000 lbs (9,000 kg)
MAXIMUM TORQUE	2,840 N/m (2,098 lbs/ft)
MAXIMUM SPEED	1500 rpm
TRANSMISSION	TWO-SPEED (3.46:1 AND 1:1)

*Chuck operation: spring closed and hydraulically opened.

FEED FRAME ASSEMBLY

	DESCRIPTION
HEAD STROKE	1.68 m (5 ft 6 in)
PULL CAPACITY	8,300 kg (18,000 lbs)
ANGLE RANGE (UNDERGROUND)	-90° to 90°
ANGLE RANGE (SURFACE)	0° to 90°

WIRELINE HOIST ASSEMBLY

	STANDARD
CABLE CAPACITY	915 m (3,000 ft)
PULL CAPACITY (EMPTY)	907 kg (2,000 lbs)
PULL CAPACITY (FULL)	295 kg (650 lbs)



VERSADRILL KmB 1.4S & KmB 1.4

SURFACE AND UNDERGROUND DRILL RIG

The Versadrill kmB 1.4 can drill up to 1,400 m (4,600 ft) using B rods and offers great driving force for deep drilling.

Designed in conjunction with industry contractors, this practical machine is perfect for surface applications, but can easily be adapted for underground drilling as well - minimizing the capital cost for organizations that offer both services. It can be made out of steel or aluminum, depending of customers' specifications, and can be mounted either on a skid, a trailer or Caterpillar tracks upon request.



Versadrill KmB 1.4S
Part No. 20-303

Versadrill KmB 1.4
Part No. 20-311

VERSADRILL KmB 1.4S

SURFACE DRILL RIG

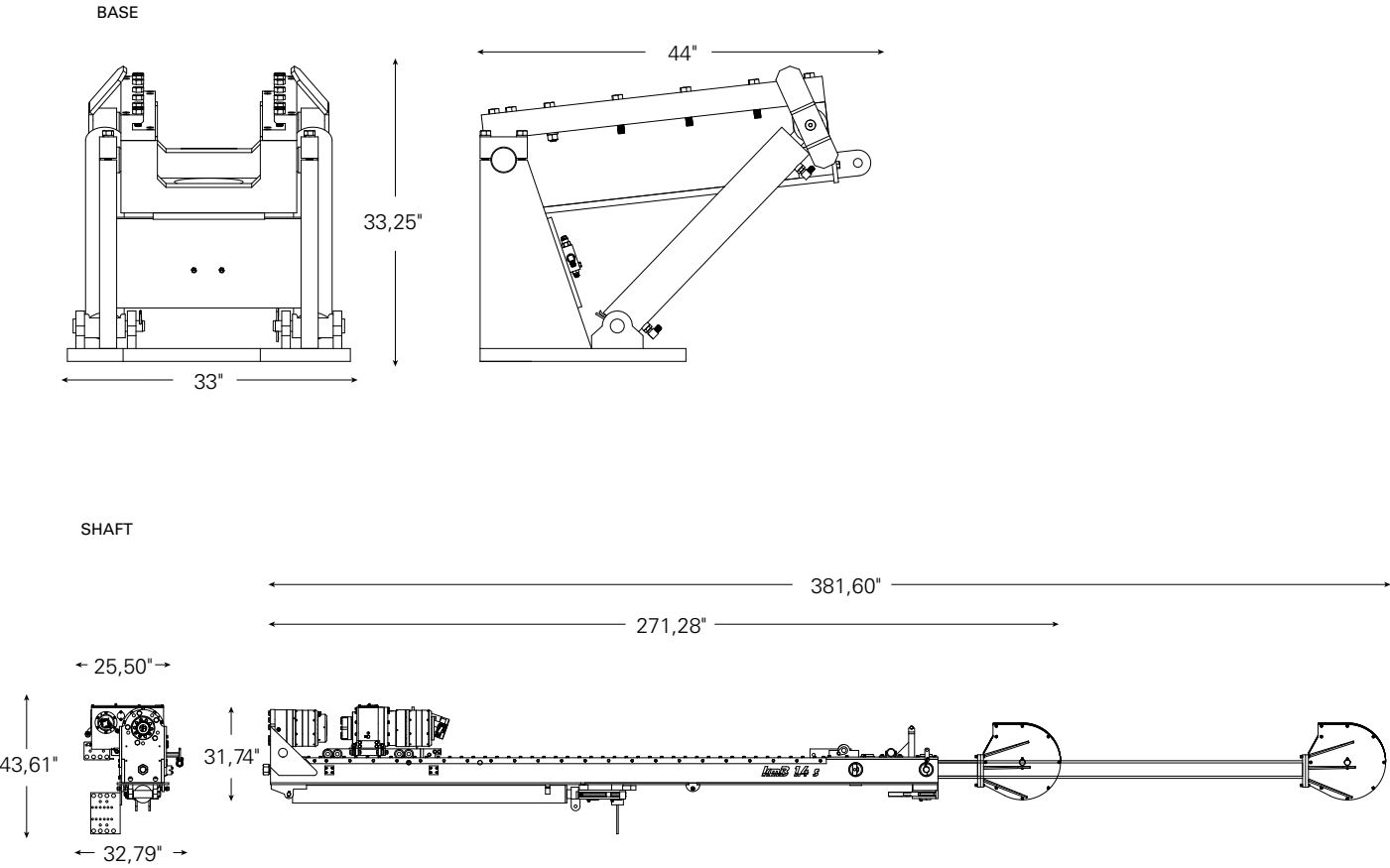

CONTROL PANEL

POWER PACK

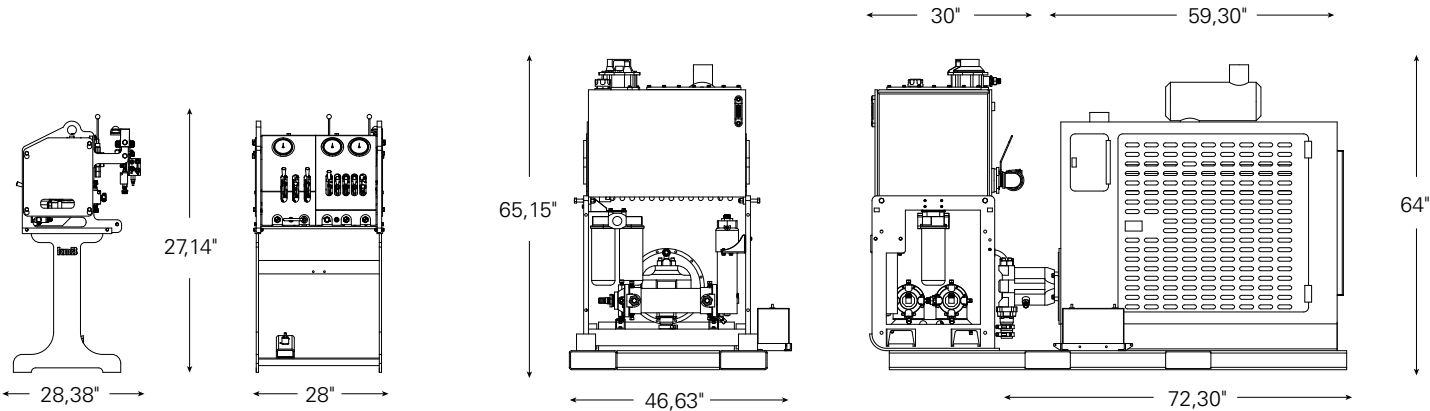

VERSADRILL KmB 1.4S

SURFACE DRILL RIG

DEPTH RATING*

SIZE	METER	FEET
BWL	1,400 m	4,600 ft
NWL	1,100 m	3,600 ft
HWL	880 m	2,900 ft
PWL	550 m	1,800 ft

*Approximation only. May vary according to soil conditions.

WEIGHT

	METRIC (kg)	IMPERIAL (lbs)
MAST ASSEMBLY	4,998 kg	11,019 lbs
POWER UNIT (WITH ELECTRIC ENGINE AND WET HYDRAULICS)	1,286 kg	2,836 lbs
CONTROL PANEL	231 kg	510 lbs
TOTAL	6,516 kg	14,365 lbs

POWER UNIT

	HP	STD/OPT
DIESEL MOTOR CUMMINS	205 HP	STANDARD
DIESEL MOTOR CUMMINS	265 HP	HIGH ALTITUDE OPTION

ROTARY HEAD ASSEMBLY

	DESCRIPTION
MOTOR*	160 cc variable
HOLDING CAPACITY	25,000 lbs (11,340 kg)
MAXIMUM TORQUE	4,196 N/m (5,689 lbs/ft)
MAXIMUM SPEED	1,250 rpm
TRANSMISSION	Mechanic Two-speed (3.46:1 and 1:1)

*Chuck operation: spring closed and hydraulically opened.

FEED FRAME ASSEMBLY

	DESCRIPTION
HEAD STROKE	3.35 m (11 ft)
PULL CAPACITY	17,336 kg (38,000 lbs)
ANGLE RANGE	-45° to -90°

WIRELINE HOIST ASSEMBLY

	STANDARD
CABLE CAPACITY	1,400 m (4,600 ft)
PULL CAPACITY (EMPTY)	907 kg (2,000 lbs)
PULL CAPACITY (FULL)	295 kg (650 lbs)

VERSADRILL KmB 1.4

SURFACE AND UNDERGROUND DRILL RIG

SHAFT

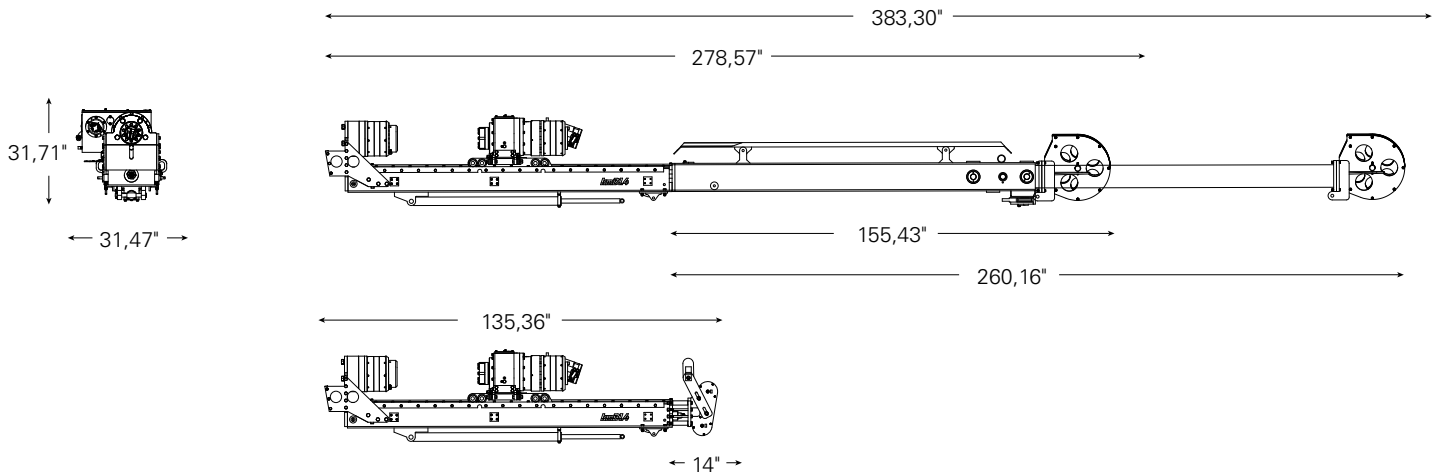

CONTROL PANEL

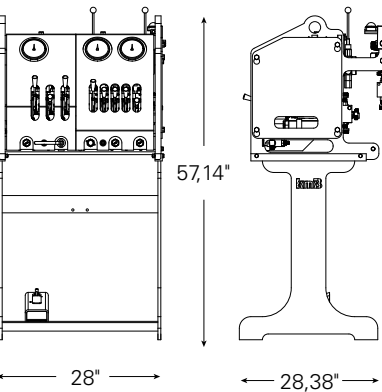

BASE

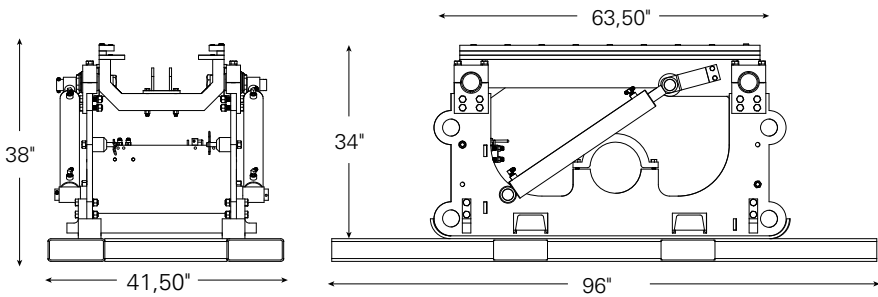

POWER PACK - ELECTRIC

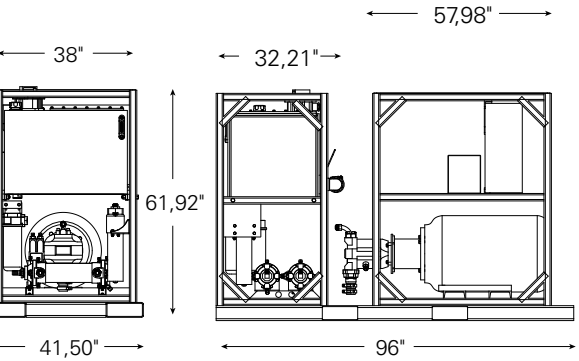

POWER PACK - DIESEL

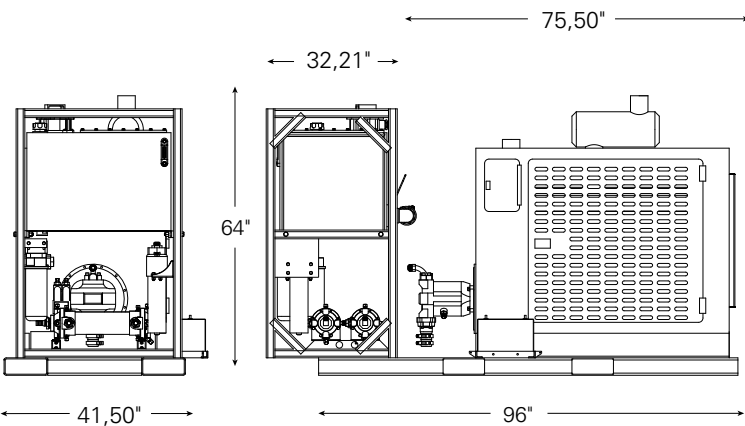

VERSADRILL KmB 1.4

SURFACE AND UNDERGROUND DRILL RIG

DEPTH RATING*

SIZE	METER	FEET
BWL	1,400 m	4,600 ft
NWL	1,100 m	3,600 ft
HWL	880 m	2,900 ft
PWL	550 m	1,800 ft

*Approximation only. May vary according to soil conditions.

WEIGHT

	METRIC (Kg)	IMPERIAL (Lbs)
MAST ASSEMBLY	1,904 kg	4,198 lbs
POWER UNIT (WITH ELECTRIC ENGINE AND WET HYDRAULICS)	1,225 kg	2,700 lbs
CONTROL PANEL	231 kg	510 lbs
TOTAL	3,360 kg	7,408 lbs

*Surface option is not included.

POWER UNIT

	HP	STD/OPT
HYUNDAI ELECTRIC ENGINE	125 HP	STANDARD
CUMMINS DIESEL ENGINE	205 HP	STANDARD
CUMMINS DIESEL ENGINE	265 HP	HIGH ALTITUDE OPTION

NOTE: Please contact your sales representative to choose the appropriate power unit according to the electrical system effective in the country of use.

ROTARY HEAD ASSEMBLY

	DESCRIPTION
MOTOR*	160 cc VARIABLE
HOLDING CAPACITY	25,000 lbs (11,340 kg)
MAXIMUM TORQUE	5,689 N/m (4,196 lbs/ft)
MAXIMUM SPEED	1,250 RPM
TRANSMISSION	MECHANIC TWO-SPEED (3.46:1 AND 1:1)

*Chuck operation: spring closed and hydraulically opened.

FEED FRAME ASSEMBLY

	DESCRIPTION
HEAD STROKE	1.68 m (5 ft 6 in)
PULL CAPACITY	11,800 kg (26,000 lbs)
ANGLE RANGE (UNDERGROUND)	-90° to 90°
ANGLE RANGE (SURFACE)	0° to 90°

WIRELINE HOIST ASSEMBLY

	STANDARD
CABLE CAPACITY	1,400 m (4,600 ft)
PULL CAPACITY (EMPTY)	907 kg (2,000 lbs)
PULL CAPACITY (FULL)	295 kg (650 lbs)

DRILL RIGS COMPARATIVE CHART

SURFACE AND UNDERGROUND DRILL RIGS

	SILVER BEAR A5 1300m N	GOLDEN BEAR 1400m N	VERSADRILL KmB .4	VERSADRILL KmB .8
APPLICATIONS	SURFACE	SURFACE	UNDERGROUND AND SURFACE	UNDERGROUND AND SURFACE
DEPTH RATING (WITH N RODS)	1,300 m / 4,350 ft	1,400 m / 4,600 ft	200 m / 655 ft	450 m / 1,475 ft
TOTAL WEIGHT	3,320 kg (7,319 lbs)	7,003 kg (15,440 lbs)	1,919 kg (4,230 lbs)	2,774 kg (6,115 lbs)
RECOMMENDED ENGINE	Diesel (140 hp)	Diesel (185 hp)	Electric (75 hp) Diesel (100 hp)	Electric (100 hp) Diesel (140 hp)
HOLDING CAPACITY	26,000 lbs (11,793 kg)	29,000 lbs (13,154 kg)	14,000 lbs (6,350 kg)	20,000 lbs (9,000 kg)
MAXIMUM TORQUE	2,341 N/m (1,727 lbs/ft)	1,880 N/m (1,386 lbs/ft)	2,840 N/m (2,098 lbs/ft)	2,840 N/m (2,098 lbs/ft)
TRANSMISSION	Two-speed (5.4:1 and 3:1)	Four-speed (6.63:1, 3.17:1, 1.72:1 and 1:1)	Two-speed (3.46:1 and 1:1)	Two-speed (3.46:1 and 1:1)
HEAD STROKE	1.83 m (6 ft)	3 m (10 ft)	1.68 m (5 ft 6 in)	1.68 m (5 ft 6 in)
ANGLE RANGE	-90° to -22°	-90° to -40°	-90° to 90° Underground 0° to -90° Surface	-90° to 90° Underground 0° to -90° Surface

DRILL RIGS COMPARATIVE CHART

SURFACE AND UNDERGROUND DRILL RIGS

	VERSADRILL kmB 1.4	VERSADRILL kmB .4S	VERSADRILL kmB .8S	VERSADRILL kmB 1.4S
APPLICATIONS	UNDERGROUND AND SURFACE	SURFACE	SURFACE	SURFACE
DEPTH RATING (WITH N RODS)	1,100m / 3,600 ft	200 m / 655 ft	450 m / 1,475 ft	1,100m / 3,600 ft
TOTAL WEIGHT	3,360 kg (7,408 lbs)	1,700 kg (3,748 lbs)	2,647 kg (5,835 lbs)	6,516 kg (14,365 lbs)
RECOMMENDED ENGINE	Electric (125hp) Diesel (205hp)	Diesel (100 hp)	Diesel (140 hp)	Diesel (205hp) Option (265hp)
HOLDING CAPACITY	25,000 lbs (11,340 kg)	14,000 lbs (6,350 kg)	20,000 lbs (9,000 kg)	25,000 lbs (11,340 kg)
MAXIMUM TORQUE	5,689 N/m (4,196 lbs/ft)	2,840 N/m (2,098 lbs/ft)	2,840 N/m (2,098 lbs/ft)	5,689 N/m (4,196 lbs/ft)
TRANSMISSION	Two-speed (3.46:1 and 1:1)	Two-speed (3.46:1 and 1:1)	Two-speed (3.46:1 and 1:1)	Two-speed (3.46:1 and 1:1)
HEAD STROKE	1.68 m (5 ft 6 in)	1.83 m (6 ft)	1.83 m (6 ft)	1.83 m (6 ft)
ANGLE RANGE	-90° to 90° Underground 0° to -90° Surface	-45° to 90°	-45° to 90°	-45° to 90°



© Gilles Savore

Rouyn-Noranda, Qc, Canada, 2006



HYDRAULIC MUD MIXERS

Having a mud mixer on the job is a must since drilling additives need a homogenous mix to maximize their lubricating and/or stabilizing properties. Fordia offers a simple mud mixer built tough for durability and reliability. It can be mounted directly on the rig’s hydraulic system in order to provide the proper blend of water and additives and a smooth and consistent mud mix.



Hydraulic Mud Mixer
Part No. 31-001

HYDRAULIC MUD MIXERS

DESCRIPTION	
HYDRAULIC MOTOR	5 gal/min @ 2 000 rpm
MAXIMUM PRESSURE	2,000 psi
POWER	5 hp
WEIGHT	15 pounds
DIMENSIONS	8.5 diameter x 12” length

